

Greetwell Gate Applications Drawings 2020/0731/RG3

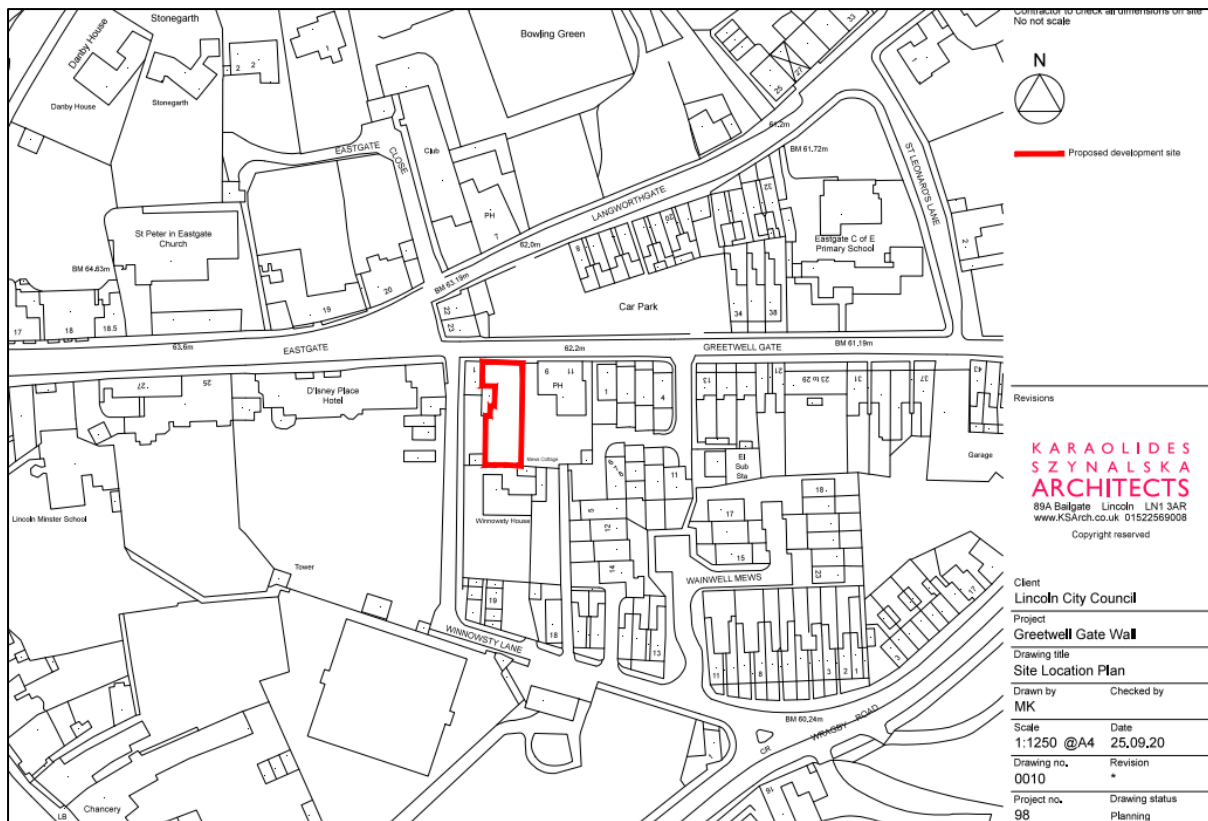

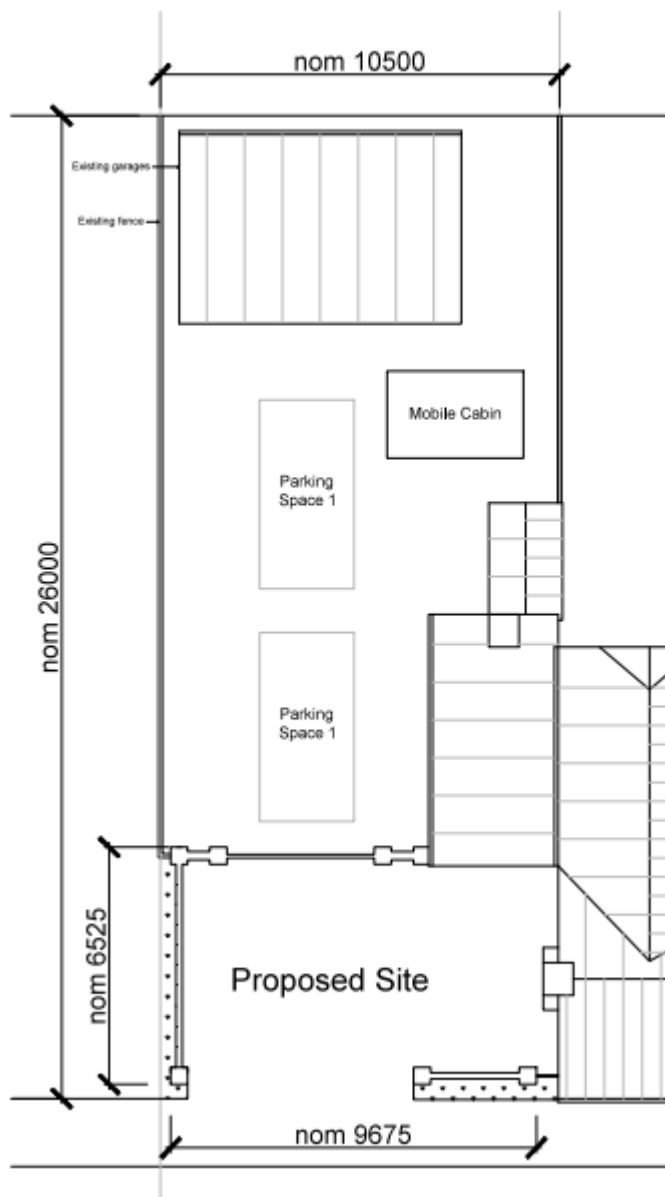

Block plan showing position of unit



ON-DEMAND, ON-SITE, ON-TIME.

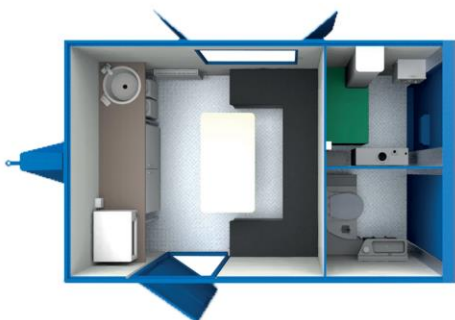

ARMADILLO ECO

A HISTORY OF INNOVATION



STANDARD SPECIFICATIONS:

Product Code	20601
Unit Name	Armadillo ECO
Dimensions	12 x 7.5ft / 3.6 x 2.3m
Configuration	6 person Canteen / 1 Toilet
Weight	1700kg
Water tank capacity	64L / 14gal. combined
Fuel tank capacity	68L / 15gal.
Waste tank capacity	132L / 29gal. Combined
Power type	Hybrid Solar
External rain shrouds	✓
EcoBoard internal lining to all walls	✓
12v sockets and 12v generator	✓
Low level removable lifting points	✓
Facilities (Canteen/WC/drying/changing room)	✓
Heating system and Auto frost protection	✓
Hot water (Canteen and WC area)	✓
Regulation forearm sink- WC area	✓
Chemical toilet	✓
Hydraulic chassis and towable	✓

MIN 1 WEEK HIRE

Comprising of a 6-man canteen, private WC facilities and drying/ changing/generator room, the Armadillo Eco is a robust and secure mobile welfare unit suitable for even the most remote and demanding of environments.

Each eco welfare unit is solar powered and backed up by a bespoke 12v super silent generator which stops and starts as required.

KEY FEATURES:

- Road towable, self-contained secure steel unit
- Fully lockable security doors
- Canteen for 6 persons
- Auto-frost protection
- Solar powered
- Reduces fuel bills by up to £100 per week
- Hot water boiler and microwave included

OPTIONAL EXTRAS AVAILABLE

- WiFi 
- Fuel, waste & water servicing
- Water dispenser
- Additional hours pack available
- Garic i-SITE Technology

Welfare unit